



WHEEL WEIGHT WITHOUT SKEWER :  
 FRONT : 865 g.  
 REAR : 1045 g.  
 WHEEL REFERENCE :  
 FRONT : M23800.  
 REAR : M 23801.

Use : **to be used only with Tubeless UST® tires on cross country mountain bikes equipped with disc brakes.** The use of any other tire, Cantilever or V-brakes or any other use (such as on a tandem, in downhill disciplines...) is inadvisable and is the sole responsibility of the user, which voids the Mavic warranty.

<b>RIM</b>			
COMMERCIAL REFERENCES	Ø VALVE HOLE	RECOMMENDED TIRE WIDTH AND PRESSURE	MAINTENANCE AND BRAKES
Front / Rear : M40621	 Valve UST® M40495 Ø 6,5 mm or Ø 8,5 mm with adapter.	 Ø 26" : Compatible ETRTO 559 x 19 <b>Tubeless UST® only.</b>  2 - 4 bars (30 - 60 PSI). <b>Tubeless UST® only.</b>	Maintenance : see page 28. Brakes : see page 30. Replacing the rim : see pages 22 & 23.
Available through the MSC.			

**HUBS**

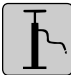
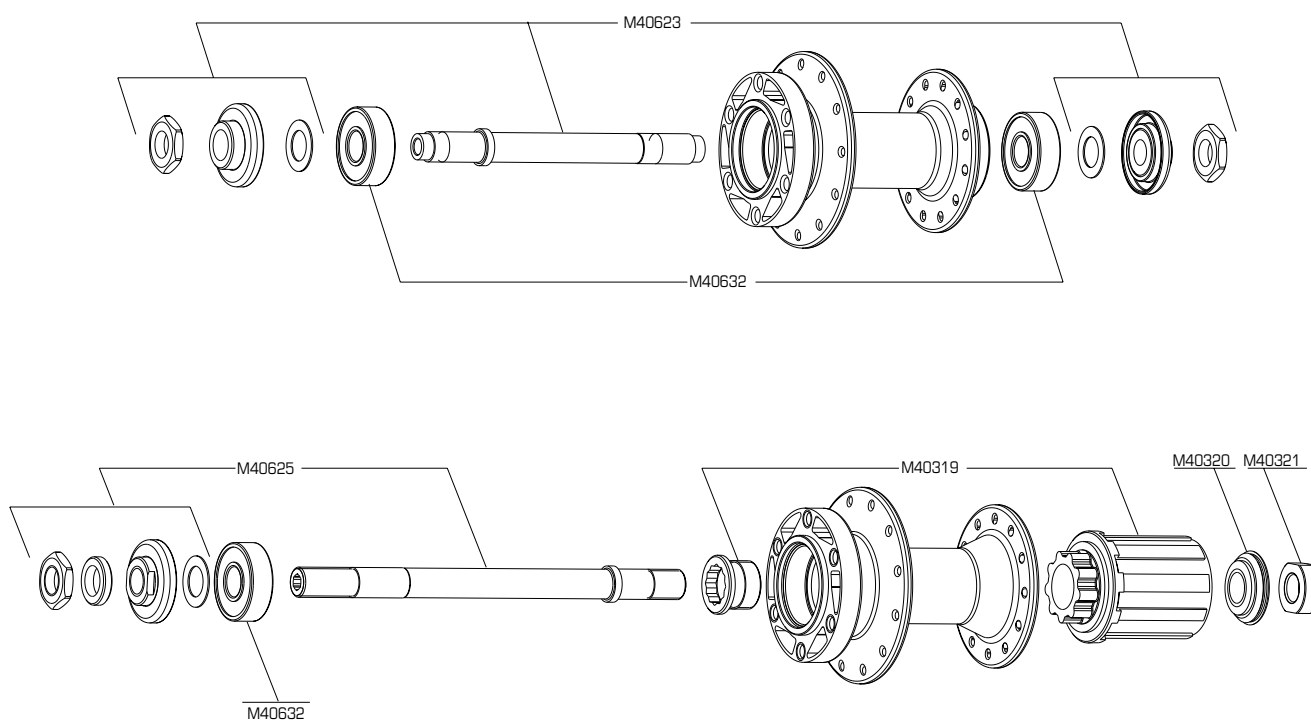

**MAINTENANCE :** Cleaning : Use a dry cloth or soap and water.  
 Do not use pressurized water. Maintenance : see pages 15, 16 & 17.

**WHEEL BUILDING**

FEATURES	TENSION	MAINTENANCE
<b>QUANTITY PER PACKAGE :</b> 12 spokes + 12 nipples. <b>NIPPLES :</b> Nickel plated brass, ABS system, 16 mm. <b>SPOKES :</b> Length and reference : Front / Rear : 260 mm / M40617. <b>LACING PATTERN :</b> Front / Rear : 2 cross pattern.	Front and Right rear : 90 - 120 kg. 110 - 140 divisions (Hozan tensionmeter).	Lateral and radial truing : see page 20. Replacing the spokes : see page 21.

**ACCESSORIES** **MISCELLANEOUS**

<b>WHEEL DELIVERED WITH :</b> <ul style="list-style-type: none"> <li>• Front quick release skewer : M40350.</li> <li>• Rear quick release skewer : M40352.</li> <li>• Valve UST® : M40495.</li> <li>• Instructions and warranty card..</li> </ul>	<ul style="list-style-type: none"> <li>• Hollow screws : M40595 (40 per pack).</li> </ul> <p><b>This kit does not come with the rim. Must be ordered separately.</b></p>
---	--