



CROSSMAX™ SL

WHEEL WEIGHT WITHOUT SKEWER :
 FRONT : 650 g.
 REAR : 820 g.

Use : **Use only on a cross country MTB equipped with a braking system on the rim.** Any other use (such as on a tandem, road bike, cyclo-cross bike,...) is highly inadvisable, and is the sole responsibility of the user, which voids the Mavic® warranty.

REF. WHEEL :
 FRONT : M25000
 REAR : M25001
 PAIR : M29081

RIM		
COMMERCIAL REFERENCES	VALVE HOLE Ø	RECOMMENDED TIRE WIDTH AND PRESSURE
Front : M40749 Rear : M40750 Do not use rim tape	 Ø : 6,5 mm UST valve M40495 Presta with Schrader adapter Length: ≥ 32 mm.	 Dimensions: Ø 26 ETRTO compatible 559 x 19 Recommended tire width: 1,5 - 2,3  Recommended tire pressure: See page 6

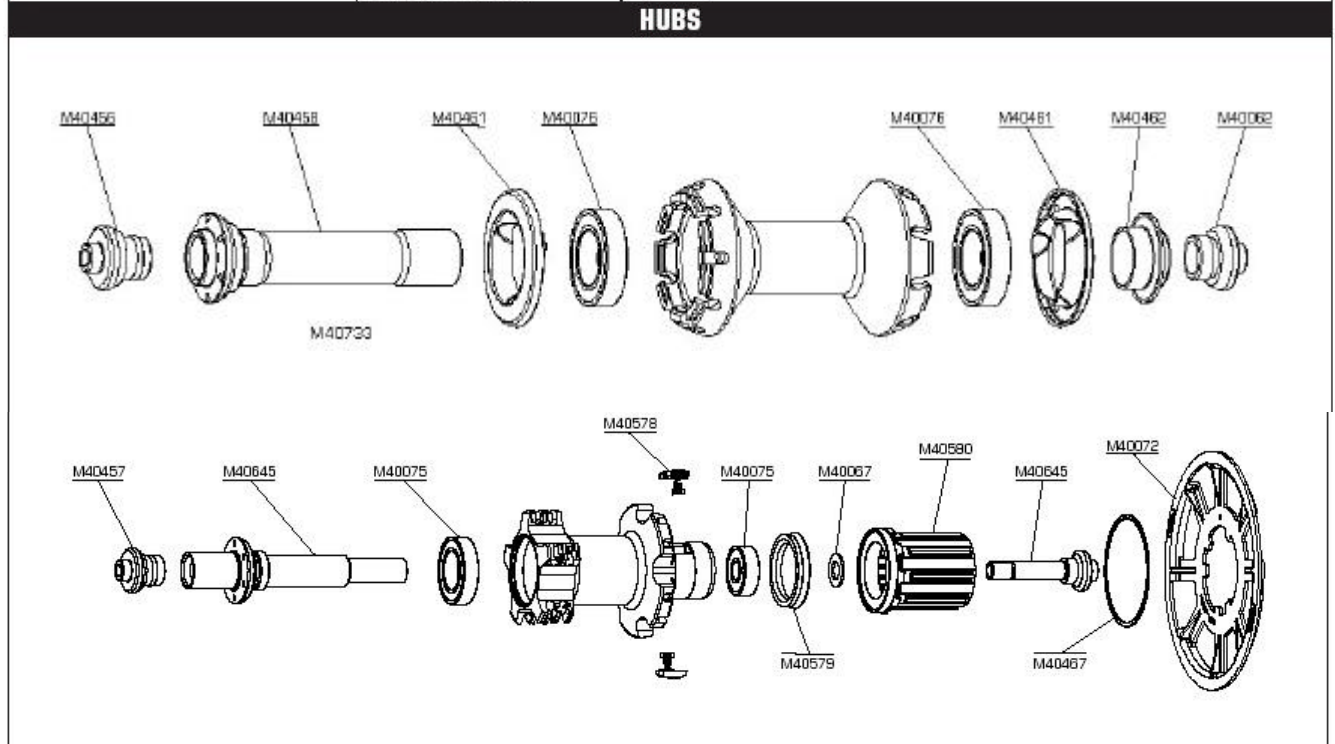

MAINTENANCE: Clean with a dry cloth or soap and water. Do not use pressurized water.
 Caution : The parts on the FTS-L free wheel (pawl assembly, springs, free wheel body) are not compatible with those on the FTS free wheel.

WHEEL BUILDING			
FEATURES :	Profiled Zicral spokes with anti-rotation system Integrated nipples with brake ring (self-locking)	LACING PATTERN :	Front : radial Rear : Isopulse concept
REFERENCE :	Front : M40751 length 255 mm (per 9) Rear CRL : M40753 length 245 mm (per 10) Rear ORL : M40755 length 274 mm (per 10)	TENSION :	Front : 120 - 130 kg Rear free wheel side: 130 - 140 kg.

ACCESSORIES	
WHEEL DELIVERED WITH : <ul style="list-style-type: none"> • Front Mavic BX601 quick release skewer: M40140 • Rear Mavic BX601 quick release skewer: M40141 • Chain Disc (with rear wheel) : M40072 • Free play adjustment wrench (with rear wheel) : M40123 	<ul style="list-style-type: none"> • UST valve : M40495 • Spoke tension and maintenance wrenches (with rear wheel) : M40494 • Computer magnet (with front wheel) : M40540 • Instructions and warranty card

MAINTENANCE			
<ul style="list-style-type: none"> • Replacing the front axle: See page 17 • Replacing the front bearings: See page 17 • Replacing the rear axle: See page 19 • Replacing the free wheel body: See page 21 	<ul style="list-style-type: none"> • Replacing the rear bearings: See page 22 • Replacing the spokes: See page 23 and 24 • Replacing the front rim: See page 27 • Replacing the rear rim: See page 28 		