



Use: **to be used only on a road bike.** Any other use (such as on a tandem, mountain bike, cyclo-cross bike) is inadvisable, and is the sole responsibility of the user, which voids the Mavic warranty.

WHEEL WEIGHT WITHOUT SKEWER:	
Clincher: Front: 690g Rear M10: 840 Rear ED10: 820g	
Tubular: Front: 680g Rear M10: 830 Rear ED10: 810g	
CLINCHER WHEEL REF: TUBULAR WHEEL REF:	
Front: M24600	Front: M24610
Rear M10: M24601	Rear M10: M24611
Rear ED10: M24602	Rear ED10: M24612

RIM			
COMMERCIAL REFERENCES	Ø VALVE HOLE	RECOMMENDED TIRE WIDTH AND PRESSURE	MAINTENANCE AND BRAKES
Front clincher: M40670 Rear clincher: M40671 Front tubular: M40668 Rear tubular: M40669	 Ø: 6,5 mm Length: ≥ 32 mm	 Ø 700: ETRTO compatible 622 x 13 Width: see page 4  See page 4	Maintenance: see pages 16 & 17 Brakes: see page 17 Replacing the rim: see 2000 Technical Manual pages 19 & 20
Available through the MSC			

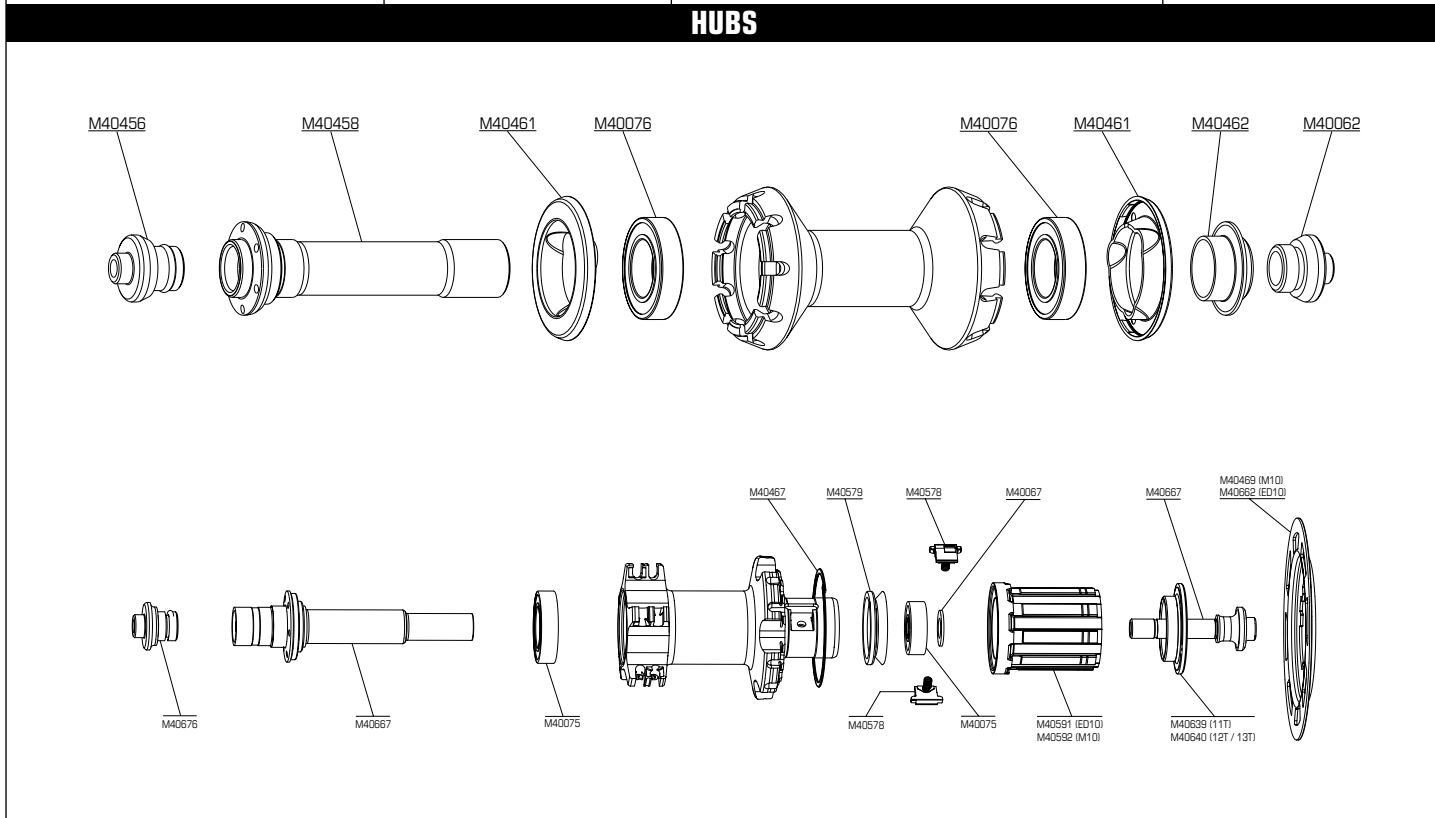

MAINTENANCE: Clean with a dry cloth or soap and water.

Do not use pressurized water. Maintenance: see page 9 and 2001 Technical Manual pages 17, 18 & 19.

Caution: the parts on the free wheel (pawl assembly, springs, free wheel body) FTS-L (2001 / 2002 version) are not compatible with those on the FTS free wheel (2000 version and before).

WHEEL BUILDING		
FEATURES	TENSION	MAINTENANCE
QUANTITY PER PACKAGE: 10 Zicral spokes with anti-rotation system and brake ring (see below). REFERENCE: Front: M40677 Right rear: M40678 Left rear: M40679 LACING PATTERN: Front: radial Right rear: radial, Isopulse system Left rear: 3 cross pattern, Isopulse system	Front: 100 à 120 kg Rear free wheel side: 130 - 150 Kg	Lateral and radial truing see 2001 Technical Manual page 20 Replacing the spokes: see 2000 Technical Manual pages 17 and 18

The spokes on the Ksyrium[®] SSC SL wheel are different than the spokes on the 2000 and 2001 Ksyrium[®] SSC, not by their length, but due to the fact that they are "self-locking" with a brake ring system compressed between the nipple and the spoke itself, at the level of the head, when the spoke tension is adjusted. Therefore, it is not necessary to glue them. These spokes can be mounted on the Ksyrium[®] SSC 2000 and 2001.

ACCESSORIES	
WHEEL DELIVERED WITH: <ul style="list-style-type: none"> • Front quick release skewer BR 601: M40149 • Rear quick release skewer BR 601: M40150 • Free play adjustment wrench: M40123 (only with the rear wheel) 	<ul style="list-style-type: none"> • Spoke maintenance and tension wrenches (delivered with the rear wheel): M40494 (only with the rear wheel) • Instructions and warranty card.