



Use : To be used only on a road bike. Any other use (such as on a tandem, mountain bike...) is inadvisable and is the sole responsibility of the user, which voids the Mavic warranty.

WHEEL WEIGHT WITHOUT SKEWER :	
FRONT : 740 g. / REAR M10 : 890 g. / REAR ED10 : 875 g.	
WHEEL REF. CLINCHER :	TUBULAR :
FRONT : M23100. M23200.	
REAR M10 : M23105. M23203.	
REAR ED10 : M23104. M23202.	

RIM			
COMMERCIAL REFERENCES	Ø VALVE HOLE	RECOMMENDED TIRE WIDTH AND PRESSURE	MAINTENANCE AND BRAKES
Front clincher : M40474. Rear clincher : M40475. Front tubular : M40472. Rear tubular : M40473.	 Ø 6,5 mm L ≥ 32 mm.	 Ø 700 : Compatible ETRTO 622 x 13 (clincher) / 633 mm (tubular). Width : see page 4.  See page 4.	Gluing : see page 29. Maintenance : see page 28. Brakes : see page 29. Replacing the rim : see 2000 Technical Manual, pages 19 and 20.
Available through the MSC.			

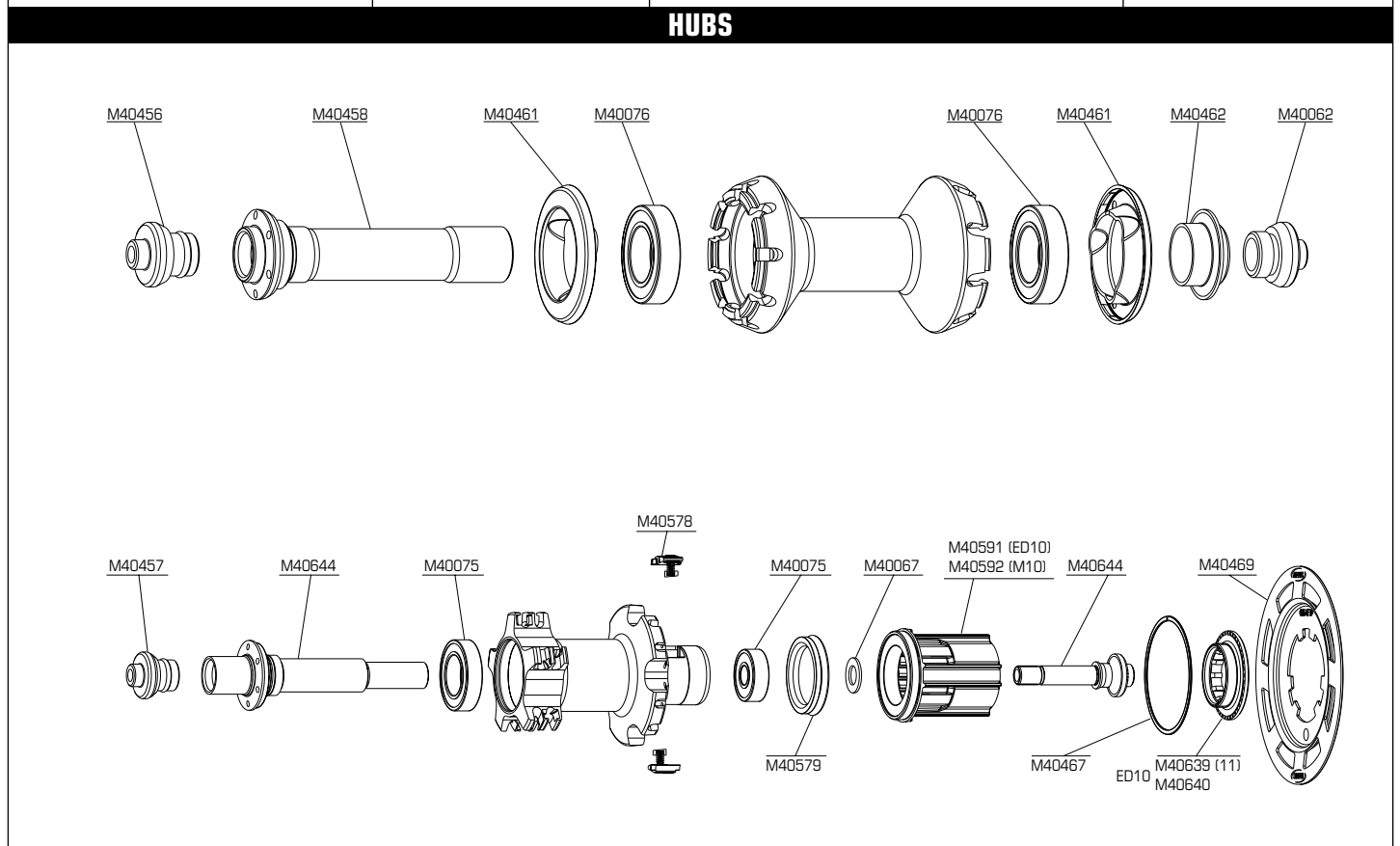

MAINTENANCE : Cleaning : Use a dry cloth or soap and water.
 Do not use pressurized water. Maintenance : see pages 15, 19 and 2000 Technical Manual, pages 11, 13 and 15.
Caution : the parts on the free wheel (pawl assembly, springs, free wheel body) FTS L (2001 version) are not compatible with those on the FTS free wheel (2000 version).

WHEEL BUILDING

FEATURES	TENSION	MAINTENANCE
QUANTITY PER PACKAGE : 10 Zicral spokes with anti-rotation system. SPOKES : Reference : Front : M40485. Right Rear : M40486. Left Rear : M40487. LACING PATTERN : Front : radial. Right Rear : radial, Isopulse system. Left Rear : 3 cross pattern, Isopulse system.	Front : 90 - 110 kg. Right Rear : 130 - 150 kg.	Lateral and radial truing : see page 20. Replacing the spokes : see 2000 Technical Manual, pages 17 and 18.

ACCESSORIES

WHEEL DELIVERED WITH : <ul style="list-style-type: none"> • Front quick release skewer Mavic BR 601 Composite : M40350. • Rear quick release skewer Mavic BR 601 Composite : M40351. • Chain Disc : M40072. • Free play adjustment wrench : M40123. 	<ul style="list-style-type: none"> • Spoke maintenance and tension wrenches (delivered with the rear wheel) : M40494. • Instructions and warranty card.
--	---