



USE : to be used only on a road bike. Any other use (such as tandem or on a mountain bike) is inadvisable and is the sole responsibility of the

### RIM

Commercial references and features		
Front	Rear	<ul style="list-style-type: none"> <li>• High resistance aluminum alloy.</li> <li>• Colorless anodization.</li> <li>• Profiled eyelet's (MAVIC patent).</li> </ul>
M40094	M40096	
Available at the M.S.C.		<ul style="list-style-type: none"> <li>• SUP - UB CONTROL  </li> <li>• Drilling :                             <ul style="list-style-type: none"> <li>- Front : 18 holes</li> <li>- Rear : 20 holes</li> </ul> </li> </ul>
M40107	16 X 622 mm	

### Rim tape

### HUB

#### Front hub :

Hardened, anodized aluminum alloy body. Adjustable, replaceable sealed cartridge bearings. Aluminum alloy axle. Spoke head rings to protect the hub from a broken spoke. Steel radial spoke ring grips. Spacing : 100 mm.

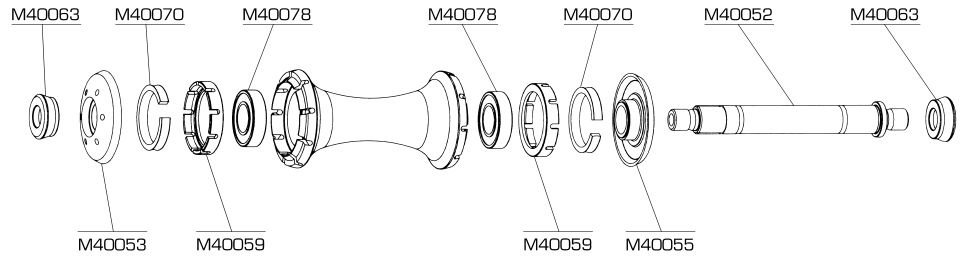

#### Rear hub :

Hardened, anodized aluminum alloy body. Integrated free wheel with FTS system. Adjustable, replaceable sealed cartridge bearings. Steel free wheel body compatible with 8 and 9 speed HG (11 teeth) or 8 and 9 speed ED (11 teeth) with the MAVIC cassette or 9 speed ED (11 teeth) with the HG/CC9 kit. Corrosion-resistant steel axle. Spoke head rings protect the hub from a broken spoke. Steel radial spoke ring grips. Spacing : 130 mm.

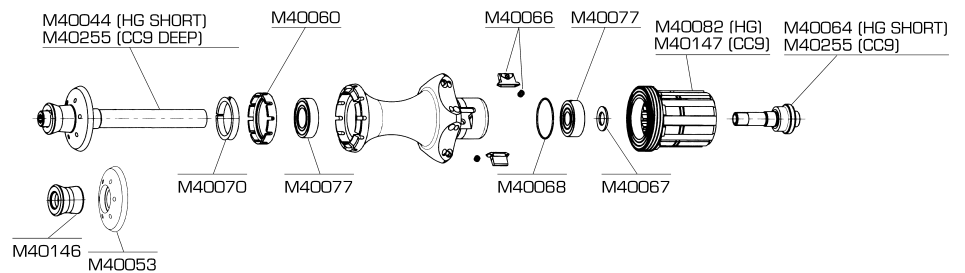

### SKEWER

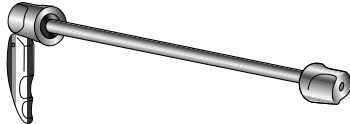
Front	Rear	
M40014	M40015	

### NIPPLES AND SPOKES

Quantity per package : 10 spokes + 10 nipples			N i p p l e s	<ul style="list-style-type: none"> <li>• Brass spoke nipples. Spherical head. Length : 16 mm.</li> </ul>
Front	Rear Left	Rear Right		S p o k e s
M40039	M40030	M40027		

user, which voids the MAVIC warranty.

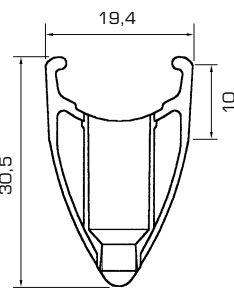
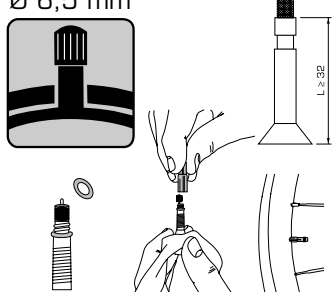
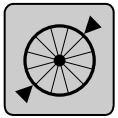
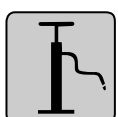
Section of the rim	Ø Valve hole and valve height	Section of the tire and recommended pressure	Maintenance and brakes
	<p>Ø 6,5 mm</p>  <p>Valve extension M40012</p>	 <p>Ø 700 Compatible ETRTO 622 X 13 (clincher) Section : 18 to 23 mm</p>  <p>MAX : 10 BAR 145 PSI MIN : 7 BAR 100 PSI</p>	<p>Maintenance : see pages 44 &amp; 45.</p> <p>Brakes : see pages 44 &amp; 45.</p>

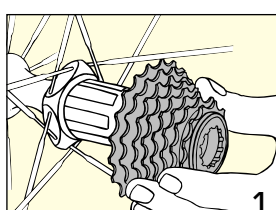
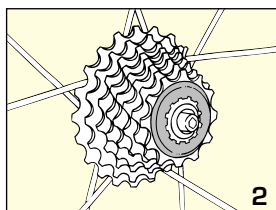
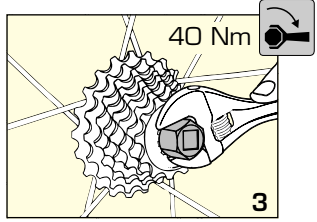
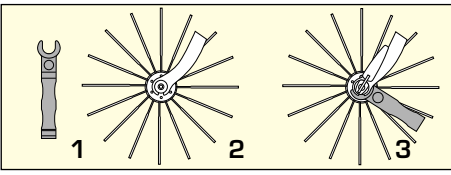
Installing the cassette 8 and 9 speed HG, 8 and 9 speed CC9 with the MAVIC cassette or HG/CC9 kit.	Adjusting the bearings	Maintenance
 <p>1</p>  <p>2</p>  <p>40 Nm</p> <p>3</p>	<p>Fasten the wheel to the frame :</p> <ol style="list-style-type: none"> <li>1- If there is free play : slightly tighten the bearing adjustment nut with the tool provided (delivered with the wheel) checking the free play at the top of the wheel.</li> <li>2- If there are tight bearings : loosen the bearing adjustment nut about 1/2 turn, unfasten the wheel, remove it from the frame and remove the skewer. Lightly hit the bearing adjustment nut side of the axle with a mallet until the axle rotates freely, refasten the wheel to the frame and adjust it as previously described.</li> </ol> <p><i>The hub of a COSMIC® EXPERT wheel has been pre-adjusted at the factory for optimum use and long life. However, free play can be modified. Free play mis-adjustments can damage the bearings on the COSMIC® EXPERT wheel or permanently alter their performance.</i></p>  <p>1 2 3</p>	<p>Cleaning : Use a dry cloth or soap and water.</p> <p>Do not use pressurized water.</p> <p>Maintenance : voir pages 35 to 38.</p>

Type		Technical information	
BR 601		Composite, high ratio closure cam. See pages 53 and 54.	
Lacing pattern		Tension	Maintenance
Front/Rear Left	Rear Right	Front/Rear Right	Lateral and radial truing : see page 34.
Radial	2 cross pattern	100 - 150 daN	Replacing the spokes : see pages 32 - 33.