



Use : To be used only with a road bike. Any other use (such as on a tandem, mountain bike...) is inadvisable and is the sole responsibility of the user, which voids the Mavic warranty.

| | |
|---------------------------------|-------------------------------|
| WHEEL WEIGHT WITHOUT SKEWER : | |
| FRONT : | 840 g. |
| REAR M10 : | 1030 g. / REAR ED10 : 1010 g. |
| REF. CLINCHER WHEEL : TUBULAR : | |
| FRONT : | M23900. M24300. |
| REAR M10 : | M23902. M24301. |
| REAR ED10 : | M23901. M24302. |

| RIM | | | |
|---|---|---|--|
| COMMERCIAL REFERENCES | Ø VALVE HOLE | RECOMMENDED TIRE WIDTH AND PRESSURE | MAINTENANCE AND BRAKES |
| Front / Rear clincher : M40614 Front / Rear tubular : M40649 |  |  Ø 700 : Compatible ETRTO 622 x 15 (clincher). Width : see page 4. | Gluing : see page 29. Maintenance : see page 28. Brakes : see page 29. |
| Available through the MSC. | Ø 6,5 mm L ≥ 32 mm. |  See page 4. | Replacing the rim : see 2000 Technical Manual, page 50. |

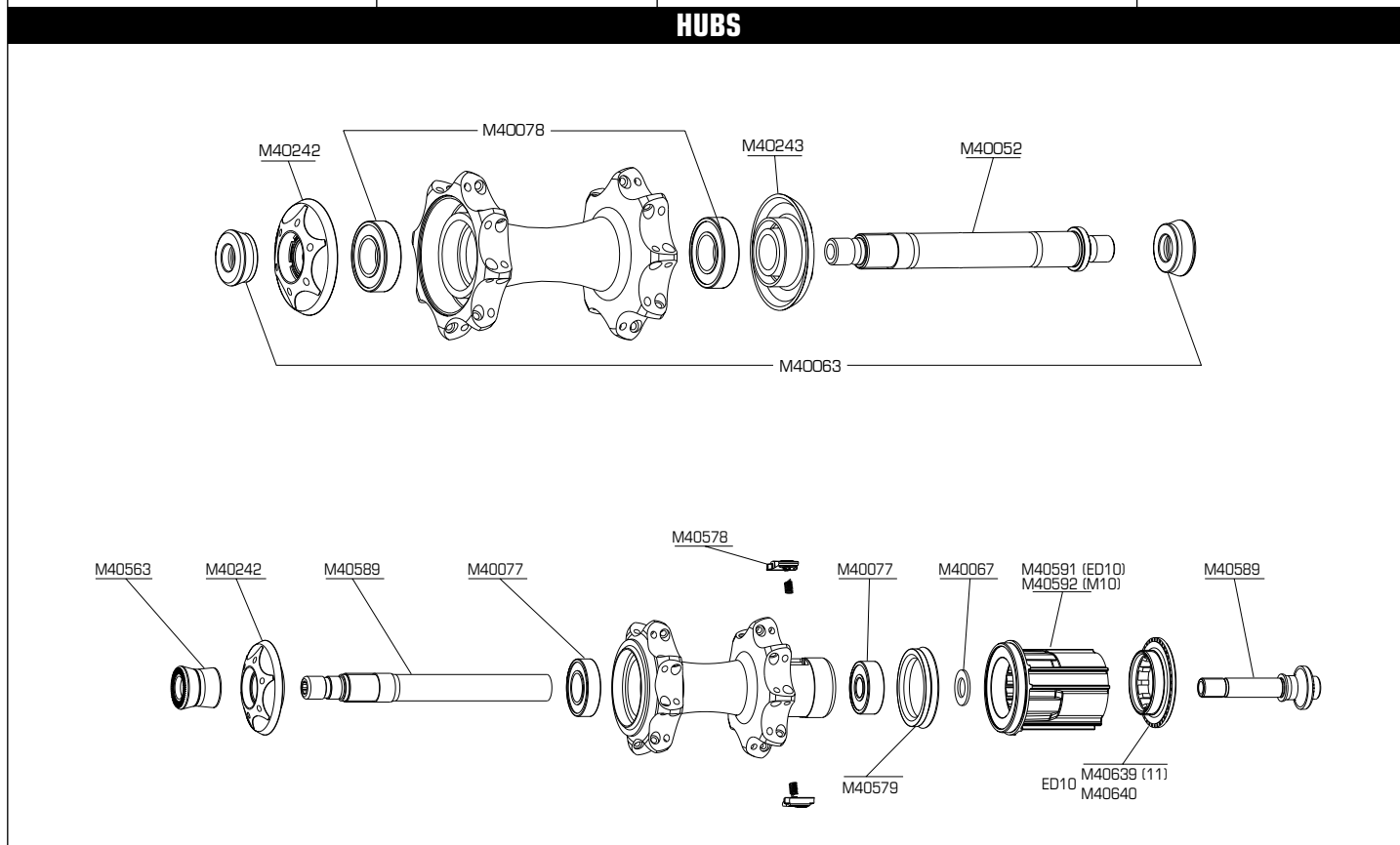

MAINTENANCE : Cleaning : Use a dry cloth or soap and water.

Do not use pressurized water. Maintenance : see pages 15, 19 and 1999 Technical Manual, pages 38, 41, 43, 46 and 47.

Caution : the parts on the free wheel (pawl assembly, springs, free wheel body) FTS L (2001 version) are not compatible with those on the FTS free wheel (2000 version).

WHEEL BUILDING

| FEATURES | TENSION | MAINTENANCE |
|---|---|---|
| QUANTITY PER PACKAGE : 10 spokes + 10 nipples. NIPPLES : Nickel plated brass, 12 mm. SPOKES : Length and reference : Front : 299 mm / M40366. Rear : 301 mm / M40364. LACING PATTERN : Front / Rear : 3 cross pattern. | Front / Right rear : 80 - 100 kg. 90 - 100 divisions (Hozan tensionmeter). | Lateral and radial truing : see page 20. Replacing the spokes : see 1999 Technical Manual, page 50. |

ACCESSORIES

| | | |
|-------------------------------|---|--|
| WHEEL DELIVERED WITH : | <ul style="list-style-type: none"> • Front quick release skewer Mavic BR 601 Composite : M40149. • Rear quick release skewer Mavic BR 601 Composite : M40150. • Rim tape 18 x 622 mm, 0,6 mm thick : M40105. | <ul style="list-style-type: none"> • Free play adjustment wrench : M40123. • Instructions and warranty card. |
|-------------------------------|---|--|