



# CLASSICS PRO

## Clincher/Tubular/HG/CC9

USE : Classic wheel designed for all types of courses, to be used exclusively on a road bike. Any other use (such as tandem or on a mountain bike)

### RIM

#### Commercial references and features

Front	Rear	<ul style="list-style-type: none"> <li>• MAXTAL aluminum alloy.</li> <li>• MAVIC black anodization.</li> <li>• Stainless steel double eyelet.</li> </ul>	  
<i>clincher version</i> M40220			
<i>tubular version</i> M40225			
Available through the M.S.C.		<ul style="list-style-type: none"> <li>• SUP - UB CONTROL - MAXTAL.</li> <li>• Drilling :             <ul style="list-style-type: none"> <li>- Front : 32 holes</li> <li>- Rear : 32 holes</li> </ul> </li> </ul>	
M40105		18 x 622 mm	

### Rim tape

### HUB

#### Front hub :

Black hardened, anodized aluminum alloy body. Adjustable, replaceable sealed cartridge bearings. Aluminum alloy axle. Spacing : 100 mm.

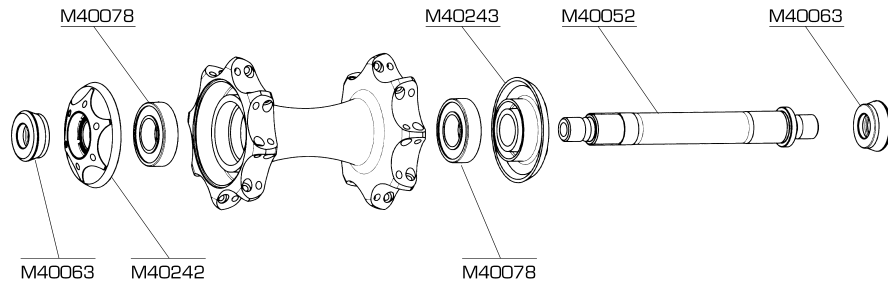

#### Rear hub :

Black hardened, anodized aluminum alloy body. Integrated free wheel with FTS system. Adjustable, replaceable sealed cartridge bearings. Steel free wheel body compatible 8 and 9 speed HG (11 teeth) or 8 and 9 speed ED (11 teeth) with the MAVIC cassette or 9 speed ED (11 teeth) with the HG/CC9 kit. Corrosion-resistant steel axle.

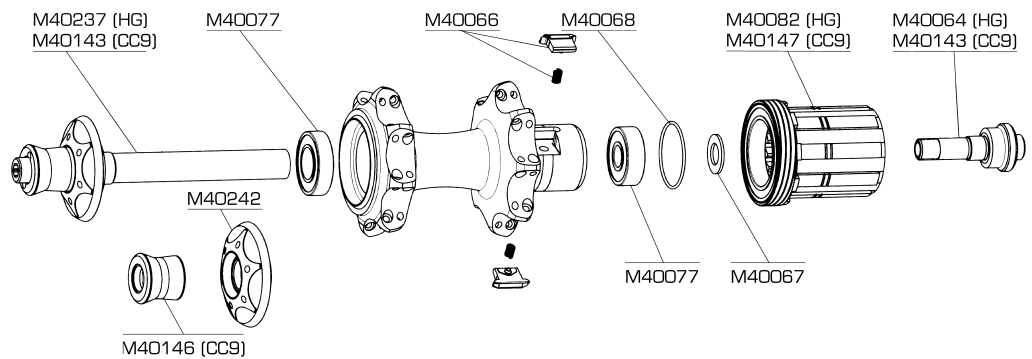

### SKEWER

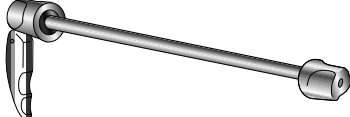
Front	Rear	
M40149	M40150	



### NIPPLES AND SPOKES

Quantity per package : 10 spokes + 10 nipples.		N i p p l e s	<ul style="list-style-type: none"> <li>• Nickel-plated brass spoke nipples.</li> <li>Length : 12 mm.</li> </ul>			
			S p o k e s	Length		<ul style="list-style-type: none"> <li>• Round straight pull spokes.</li> <li>Thread M2.</li> <li>Ø : 1.8 mm in center 2 mm at ends.</li> <li>Stainless steel.</li> </ul>
	Front/Rear L	Rear R		Front/Rear L	Rear R	
Tubular	M40043	M40213		305 mm	303 mm	
Clincher	M40212	M40211	301 mm	299 mm		

Wheel weight without skewer - Front : 770 g - Rear : 980 g. (clinchier version).

bike...) is inadvisable and is the sole responsibility of the user, which voids the MAVIC warranty.

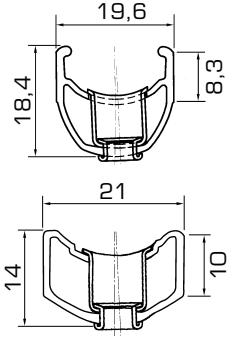
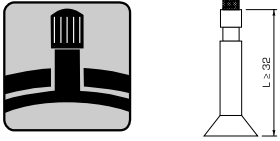
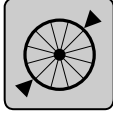
ROAD

Section of the rim	Ø Valve hole and valve height	Section of the tire and recommended pressure	Gluing, maintenance and brakes
	<p>Ø 6,5 mm</p> 	 <p>Ø 700 Compatible ETRTO 622 X 15 mm (clinchier) 633 mm (tubular) Section : 18 - 23 mm</p>  <p>MAX : 10 BAR 145 PSI MIN : 7 BAR 100 PSI</p>	<p>Gluing : see pages 44 and 45. Maintenance : see pages 44 and 45. Brakes : see pages 44 and 45.</p>

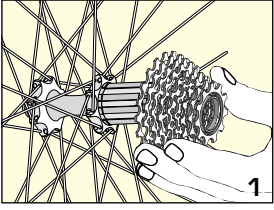
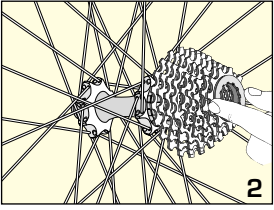
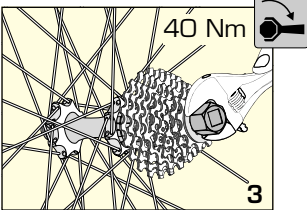
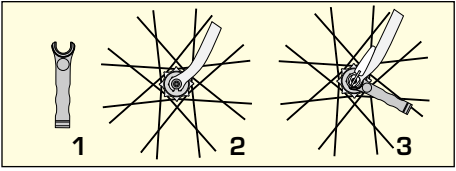
Installing the cassette 8 and 9 speed HG, 8 and 9 speed CC9 with the MAVIC cassette or the HG/CC9 kit.	Adjusting the bearings	Maintenance
  	<p>Fasten the wheel to the frame :</p> <ol style="list-style-type: none"> <li>1- If there is free play : slightly tighten the bearing adjustment nut with the tool provided (delivered with the wheel) checking the free play at the top of the wheel.</li> <li>2- If there are tight bearings : loosen the bearing adjustment nut about 1/2 turn, unfasten the wheel, remove it from the frame and remove the skewer. Lightly hit the bearing adjustment nut side of the axle with a mallet until the axle rotates freely, refasten the wheel to the frame and adjust it as previously described.</li> </ol> <p><i>The hub of the CLASSICS® PRO wheel has been pre-adjusted at the factory for optimum use and long life. However, free play can be modified. Free play mis-adjustments can damage the bearings on the CLASSICS® PRO wheel or permanently alter their performance.</i></p> 	<p>Cleaning : Use a dry cloth or soap and water. Do not use pressurized water. Maintenance : see pages 35 - 38.</p>

Type	Technical information	
BR 601 Composite.	Composite, high ratio closure cam. See pages 53 and 54	
Lacing pattern	Tension	Maintenance
<p>Front/Rear 3 cross pattern.</p>	<p>Front/Rear Right 90 - 110 daN</p>	<p>Lateral and radial truing : see page 34. Replacing the spokes : see pages 32 - 33.</p>