

501 HUB

Weight

Front : 163 g (without skewer) - Rear : 204 g (without skewer).

Features

Hardened, polished anodized alloy body. - Adjustable, replaceable sealed cartridge bearings.
Compatible with screw-on free wheel. 6, 7 or 8 speeds.
Thread 1.370 X 24 TPI.
Aluminum alloy axle
Delivered with MAVIC steel skewers.

Spacing

Front : 100 mm. Adjustable rear : 127 mm (6/7 speeds) - 130 mm (8 speeds).
Spacing adjustment 38/42 mm.

Drilling

Front/Rear : 28 - 32 - 36 holes.
Drilling holes : - Ø : 2.5 mm
- bevelled at 45°, 1 hole out of 2 and 1 side out of 2 (see diagram in mounting recommendations).
- Ø between 2 opposite holes : - Front : 40 mm
- Rear : 45 mm

Flange

Between-flanges : Front : 53 mm - Rear : 50 mm.
Distance center to flanges : Rear Left : 31.5 mm - Rear Right : 16.5 mm.

Installing the free wheel

Before installing the free wheel body, grease the thread on the rear hub.

Commercial references

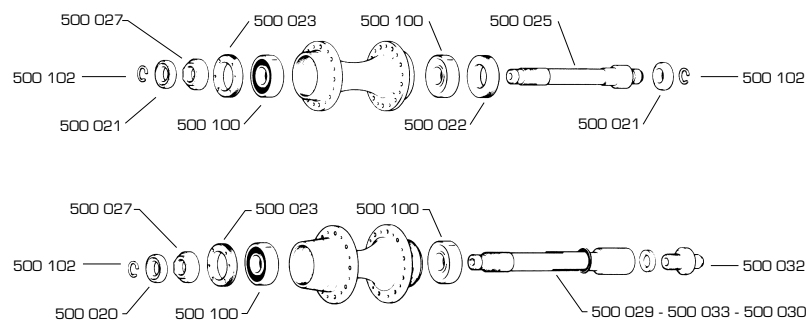

Maintenance

Cleaning : with a dry cloth or soap and water. Do not use pressurized water.

Maintenance : no lubrication is necessary, the industrial bearings used have been lubricated for life.

Bearing adjustment :

Fasten the wheel to the frame.

- 1 If there is free play : slightly tighten the bearing adjustment nut 500027 using a 15 mm cone wrench, checking the free play at the top of the wheel.
- 2 If the bearings are tight, loosen the bearing adjustment nut 500027 about 1/2 turn, unfasten the wheel, remove it from the frame and remove the skewer. Lightly hit the brake nut side of the axle with a mallet until the axle rotates freely, refasten the wheel to the frame and adjust it as previously described.

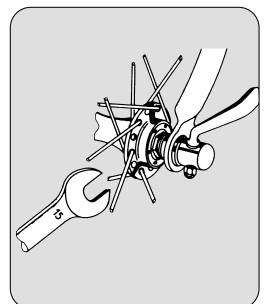

The 501 hub has been adjusted at the factory for optimum use and long life. However, free play can be modified.

Free play misadjustments can damage the bearings on the 501 hub or seriously alter their performance.

Replacing the bearings or the axle :

Disassembly.

Remove the clips 500102 as well as the rings 500020 or 500021, clamp the axle 500030 or 500025 in a vice using vice caps. Loosen the brake nut 500027, remove the axle, remove the washers 500022 and 500023, and remove the bearings.

Assembly : after cleaning the body, assemble in the opposite order.

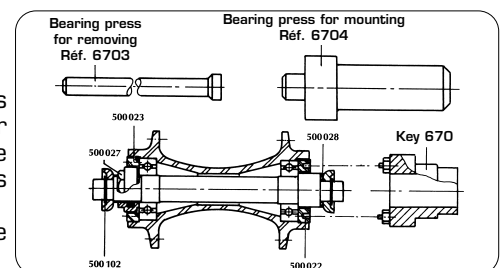

Use

To be used exclusively on a road bike only.

Any other use (such as tandem or on a mountain bike) is not recommended and is the sole responsibility of the user, which voids the MAVIC warranty.