

SPARE PARTS REFERENCES

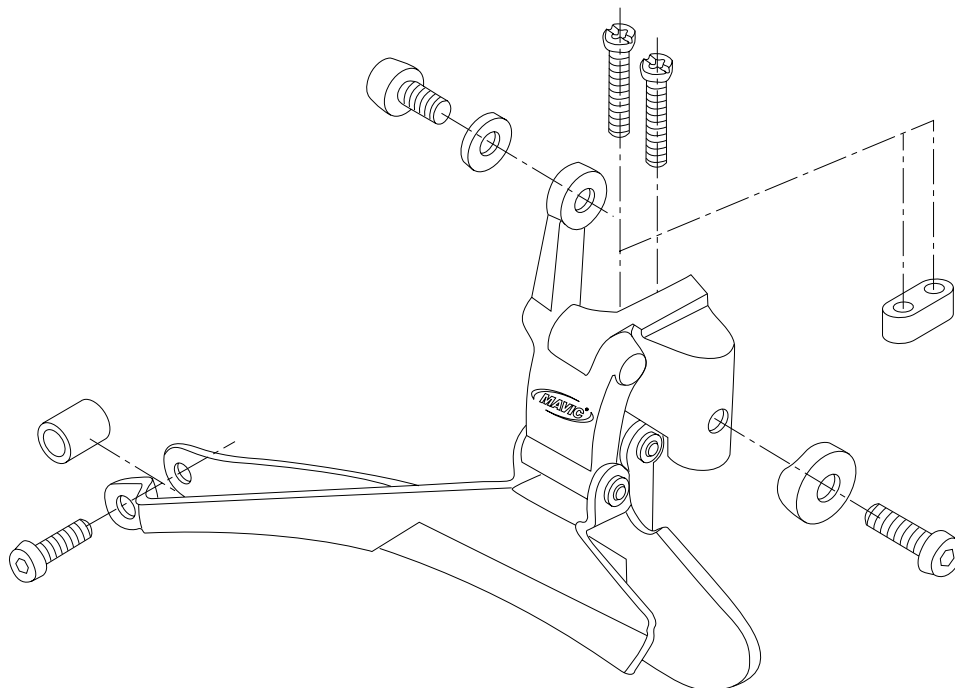

MAINTENANCE

TOOLS NEEDED :

- Oil.
- Grease.

The following operations have to be done 2 - 3 times per season especially in wet conditions.

The parallelogram arms mechanism :

- 1 First clean the derailleur.
- 2 Lubricate parallelogram arm axles with oil on the parallelogram arm pivots.
- 3 Wipe off the surplus oil.
- 4 Make sure the derailleur functions properly.

Return mechanism :

- 1 First clean the derailleur.
- 2 Lubricate the return springs with grease on the spring / parallelogram arm contact points.
- 3 Wipe off the surplus grease.
- 4 Make sure the derailleur functions properly.

TROUBLESHOOTING

TOOLS NEEDED :

- Oil. / • Grease. / • 1 flat screwdriver (5 mm blade). / • 1 x 3 mm Allen wrench. / • 1 x 5 mm Allen wrench.

Replacing the stop screw.

- 1 Completely loosen the stop screw on the derailleur with a flat screwdriver.
- 2 Clean the front derailleur.
- 3 Replace and tighten the derailleur stop screw with a flat screwdriver.
- 4 Adjust the stops (see the installing instructions).

Replacing the cage spacer.

- 1 Loosen the spacer bolt with the 3 mm Allen wrench. Remove it and the spacer.
- 2 Clean the front derailleur.
- 3 Replace the unit and tighten the spacer bolt with the 3 mm Allen wrench. **Torque: 3 - 4 Nm.**

Replacing the cable tightening screw.

- 1 Loosen the cable tightening screw with the 5 mm Allen wrench.
- 2 Clean the front derailleur.
- 3 Replace the unit. Tighten the cable tightening screw with the 5 mm Allen wrench after having adjusted the cable tension (see installing instructions). **Torque : 5 - 7 Nm.**